

Ferrite for Switching Power Supplies

SMD cores

EE/ER/EEM series

Issue date: February 2010

- All specifications are subject to change without notice.
 - Conformity to RoHS Directive: This means that, in conformity with EU Directive 2002/95/EC, lead, cadmium, mercury, hexavalent chromium, and specific bromine-based flame retardants, PBB and PBDE, have not been used, except for exempted applications.
-

Ferrite for Switching Power Supplies

SMD Cores

EE5, EE8.9/8

ER9.5/5, ER11/3.9, ER11/5

ER14.5/6

EEM12.7/13.7

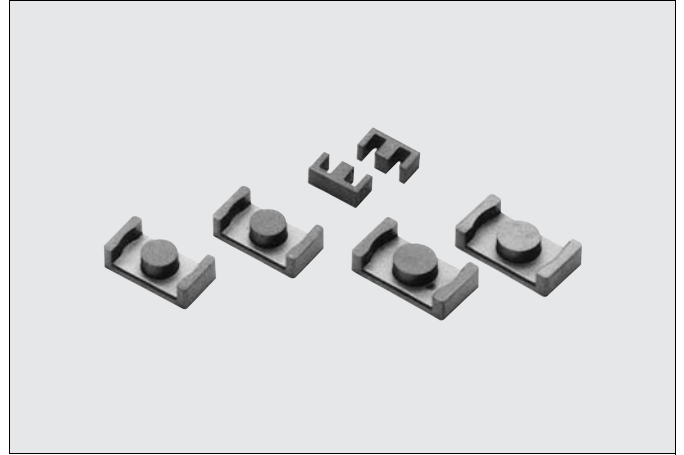

Ordering Code System

Material PC44 Size of E core ER9.5/5 – AL-value(Z: without air gap) A100

EE, ER AND EEM CORES

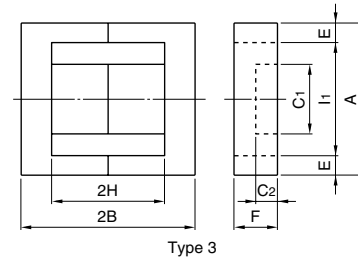
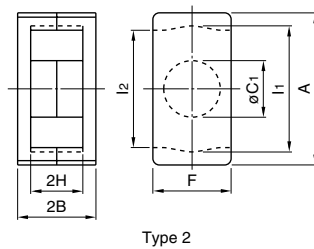
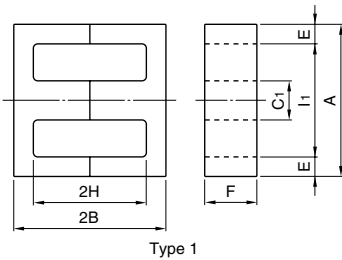
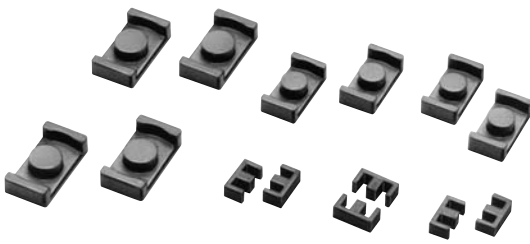

Part No.	Type	Dimensions in mm								
		A	2B	C1	C2	E	F	2H	l1	l2
PC44EE5-Z	1	5.25±0.05	5.3±0.1	1.35±0.05		0.70±0.05	1.95±0.05	4.0	3.85	
PC44EE8.9/8-Z	1	8.86±0.20	8.0±0.3	1.90±0.12		1.91±0.20	1.90±0.12	4.5±0.3	5.08 min.	
PC44ER9.5/5-Z	2	9.35±0.15	4.9±0.1	3.4±0.1			4.9±0.1	3.35±0.15	7.63±0.13	7.0 min.
PC44ER11/3.9-Z	2	10.83±0.18	3.85±0.10	4.13±0.13			5.9±0.1	2.10±0.15	8.85±0.15	7.9 min.
PC44ER11/5-Z	2	10.83±0.18	4.9±0.1	4.13±0.13			5.9±0.1	3.15±0.15	8.85±0.15	7.9 min.
PC44ER14.5/6-Z	2	14.5±0.2	5.9±0.1	4.7±0.1			6.7±0.1	3.3±0.2	11.8±0.2	11.8±0.2
PC44EEM12.7/13.7-Z	3	12.75±0.25	13.7±0.3	6.0±0.1	1.85±0.10	1.7±0.1	3.30±0.15	9.1±0.3	9.0 min.	

Part No.	Effective parameter				Electrical characteristics		Weight (g)
	C1 (mm ⁻¹)	Ae (mm ²)	∅e (mm)	Ve (mm ³)	AL-value (nH/N ²)* Without air gap	With air gap	
PC44EE5-Z	4.72	2.67	12.6	33.6	200 min.		0.2
PC44EE8.9/8-Z	3.15	4.96	15.6	77.4	480±25%		0.6
PC44ER9.5/5-Z	1.68	8.47	14.2	120	610 min. 750±25%	63±5% 100±7%	0.6
PC44ER11/3.9-Z	1.08	11.7	12.6	147	1040 min. 1100±25%	63±5% 100±7%	0.8
PC44ER11/5-Z	1.24	11.9	14.7	175	870 min. 960±25%	63±5% 100±7%	1.0
PC44ER14.5/6-Z	1.08	17.6	19.0	334	1280 min. 1150±25%	100±5% 160±7%	1.8
PC44EEM12.7/13.7-Z	2.28	12.0	27.3	328	820±25% 580±25%	40±5% 63±7%	1.9

* AL-value: 1kHz, 0.5mA, 100Ts